

PRZED ROZPOCZĘCIEM MONTAŻU ZAPOZNAĆ SIĘ Z INSTRUKCJĄ

Narzędzia niezbędne do montażu (nie dostarczane przez producenta)

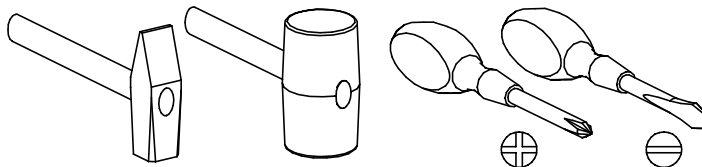
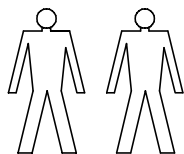

CARMELO

08

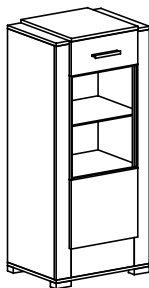

Nr	Nazwa elementu	Dł [mm]	Szer [mm]	Gr [mm]	Ilość	Kod	Paczka
1	wieniec	527	397	16	1		
2	blat dolny	560	416	16	1		
3	blat górny	560	416	16	1		
4	poprzeczka dolna	380	153	16	1		
5	nakładka blatu górnego	434	400	16	1		
6	bok lewy	1193	400	16	1		
7	bok prawy	1193	400	16	1		
8	listwa lewa	1193	90	16	1		
9	listwa prawa	1193	90	16	1		
10	HDF ściana tylna	1214	273	2,5	1		
11	półka szklana	525	385	6	1		
12	drzwi górne ramki	174	400	16	1		
13	drzwi dolne ramki	351	400	16	1		
14	drzwi szklane	528	399	20	1		
15	HDF ściana tylna	1214	273	2,5	1		

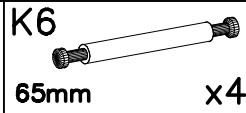
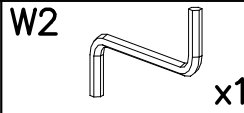
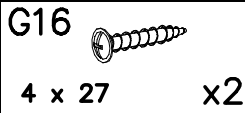
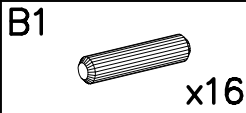
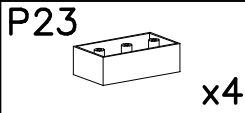
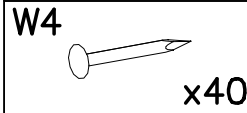
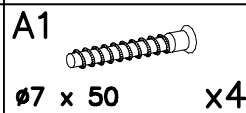
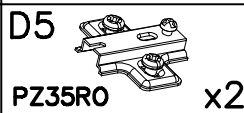
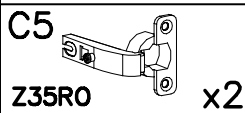
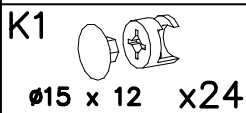
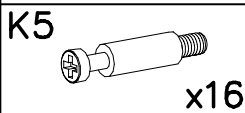
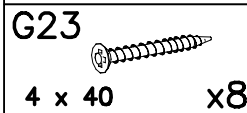
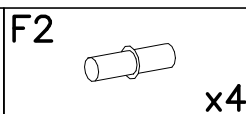
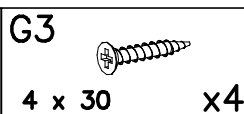
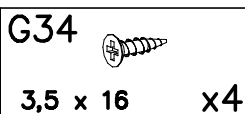
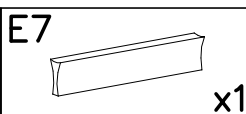
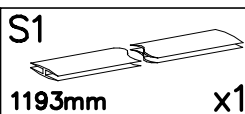
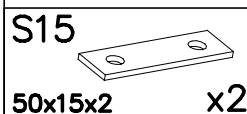
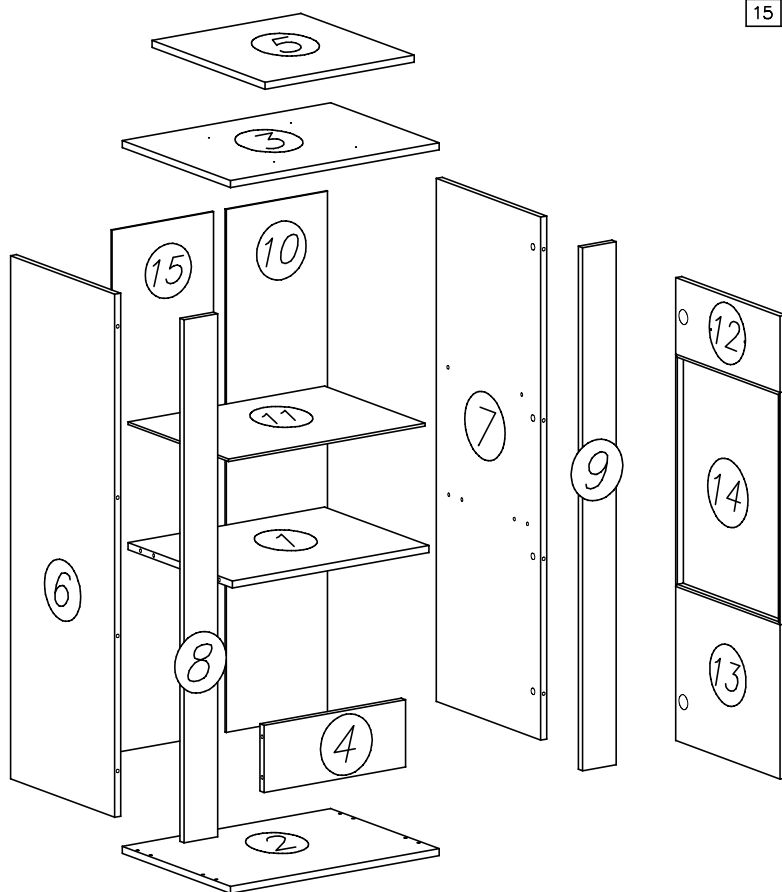

I

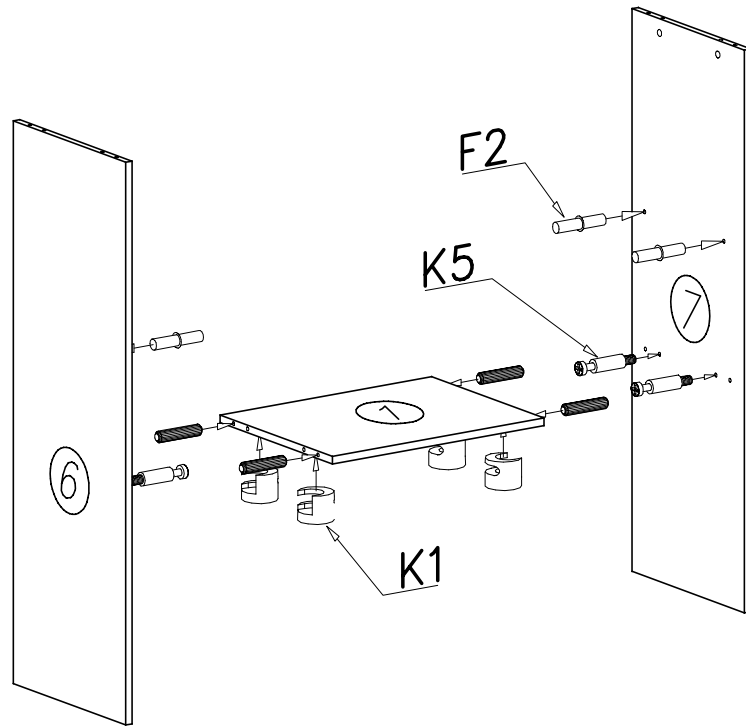

II

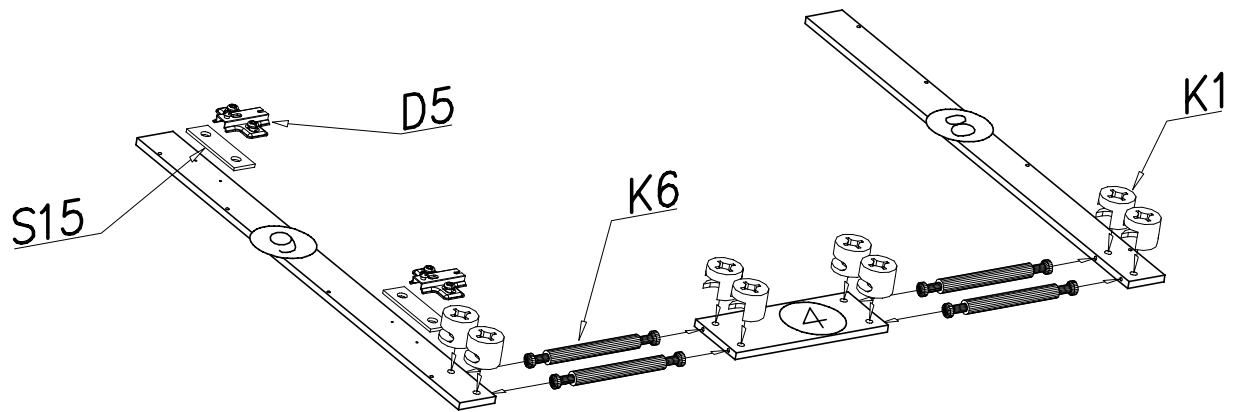

III

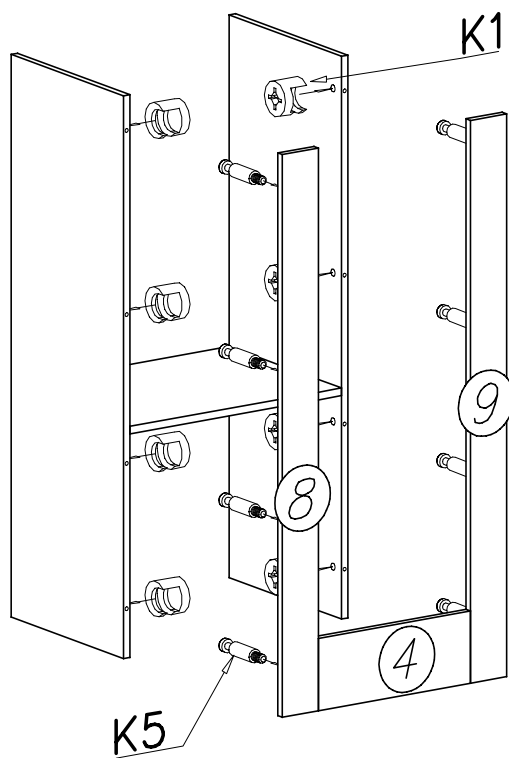

IV

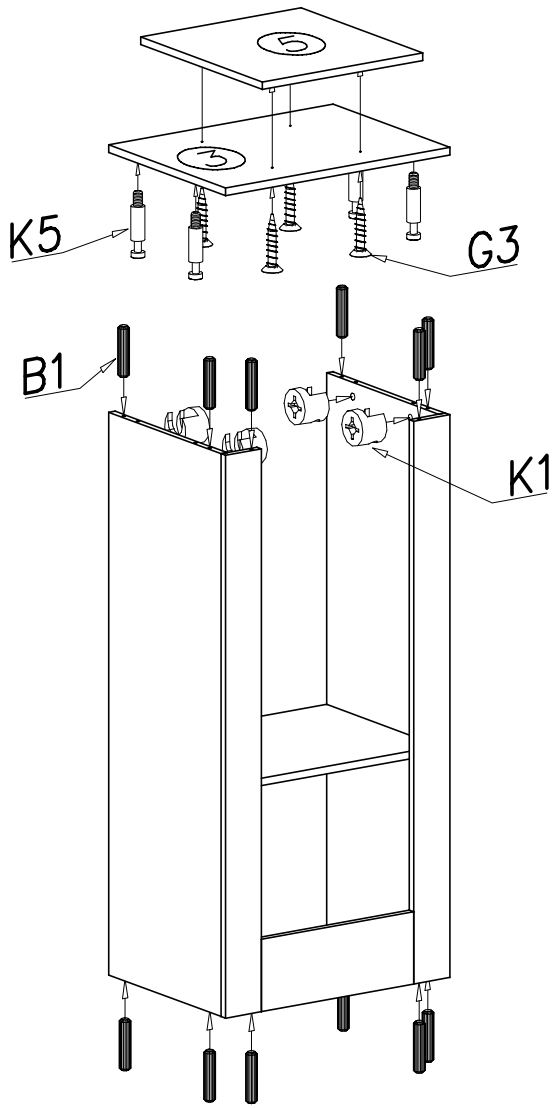

V

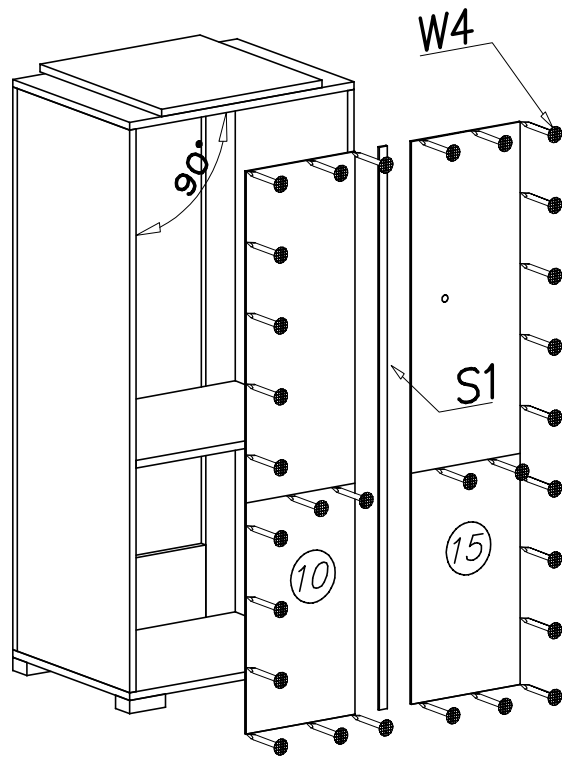

VI

