

ŁÓŻKO 90

INSTRUKCJA MONTAŻU MONTAGEANLEITUNG

NR 25

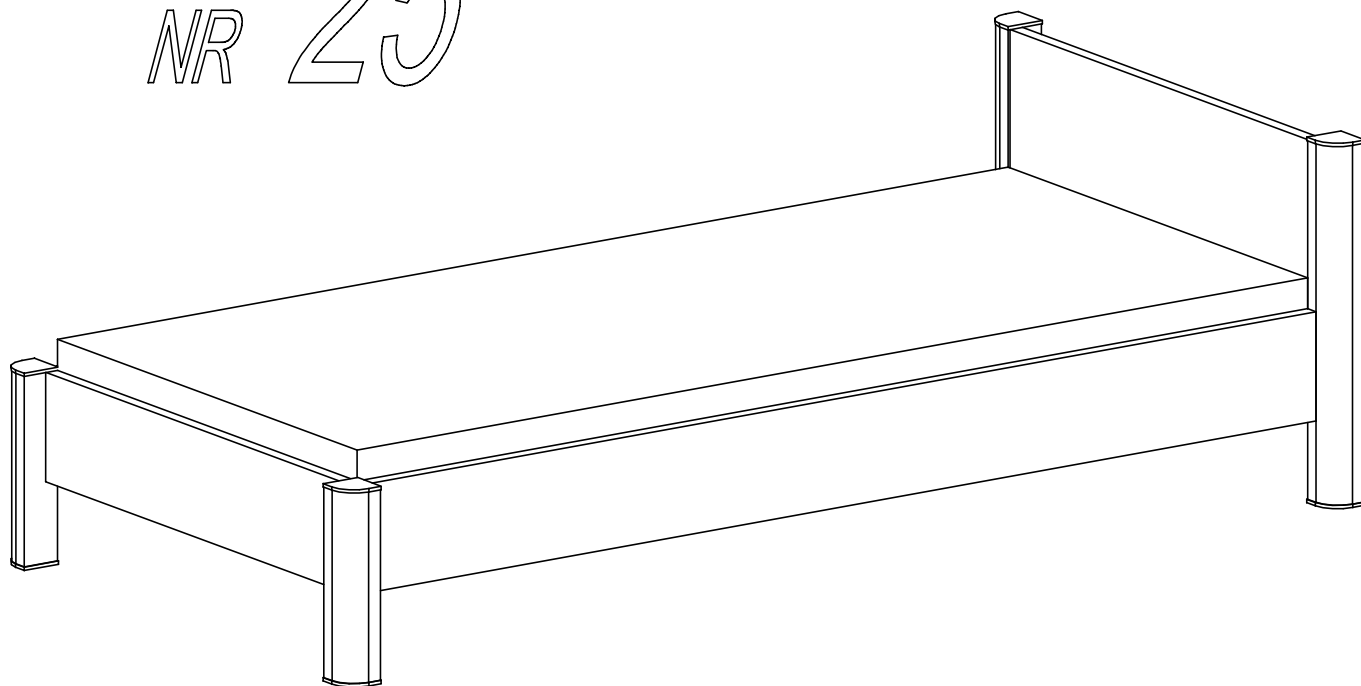

Narzędzia niezbędne do montażu (nie dostarczane przez producenta)
Zur Montage benötigte Werkzeuge (nicht vom Hersteller mitgeliefert)

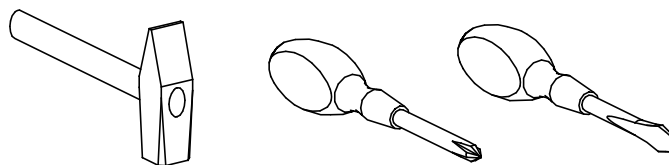

MONTOWAĆ NA MIEKKIM PODŁOŻU TYPU: KOC, DYWAN.

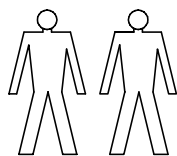

PRZED ROZPOCZĘCIEM MONTAŻU ZAPOZNAĆ SIĘ Z INSTRUKCJĄ
BITTE MONTAGEANLEITUNG BEACHTEN

W PRZYPADKU REKLAMACJI PROSZĘ OZNACZYĆ
NUMER SERII OPISANY NA ETYKIECIE OPAKOWANIA

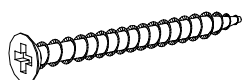

H - 12 St.
5 x 50 mm

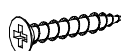

E - 4 St.
4 x 30 mm

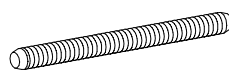

D - 10 St.
M8 x 95 mm

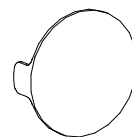

C - 10 St.

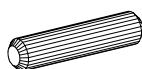

L - 18 St.

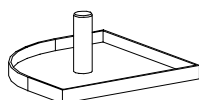

K - 8 St.

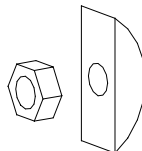

S - 10 St.

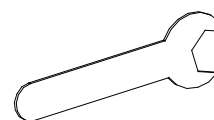

T - 1 St.