

INSTRUKCJA MONTAŻU
MONTAGEANLEITUNG

SZAFKA
NR 23

Narzędzia niezbędne do montażu (nie dostarczane przez producenta)
Zur Montage benötigte Werkzeuge (nicht vom Hersteller mitgeliefert)

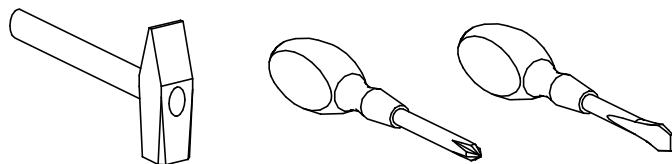

MONTOWAĆ NA MIEKKIM PODŁOŻU TYPU: KOC, DYWAN.

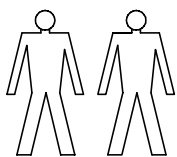

PRZED ROZPOCZĘCIEM MONTAŻU ZAPOZNAĆ SIĘ Z INSTRUKCJĄ
BITTE MONTAGEANLEITUNG BEACHTEN

W PRZYPADKU REKLAMACJI PROSZĘ OZNACZYĆ
NUMER SERII OPISANY NA ETYKIECIE OPAKOWANIA

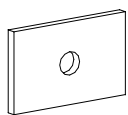

U - 16 St.

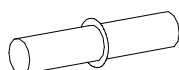

R - 12 St.

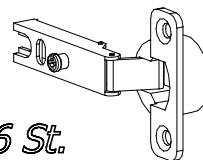

M - 6 St.

H=0

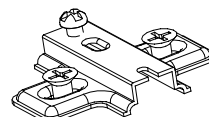

W - 6 St.

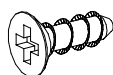
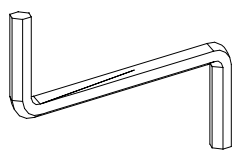

D - 24 St.
4 x 16 mm

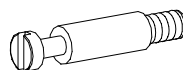

S - 8 St.

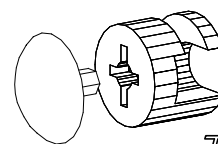

T - 8 St.

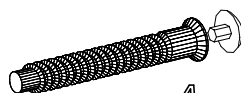

A - 20 St.
7 x 50 mm

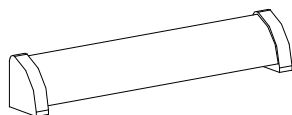

E - 4 St.

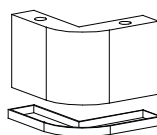

K - 5 St.



P - 10 St.
3 x 13 mm

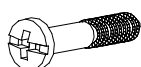

B - 8 St.

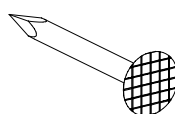

F - 78 St.

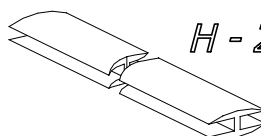

H - 2 St.



L - 54 St.

H=4

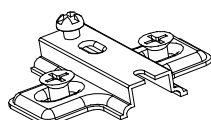

C - 6 St.

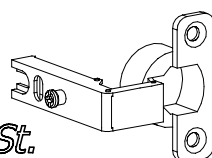

G - 6 St.

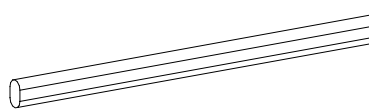

J - 1 St.

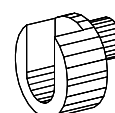

N - 2 St.