

INSTRUKCJA MONTAŻU
MONTAGEANLEITUNG

SZAFKA

NR 22

MONTOWAĆ NA MIĘKKIM PODŁOŻU TYPU: KOC, DYWAN.

Narzędzia niezbędne do montażu (nie dostarczane przez producenta)
Zur Montage benötigte Werkzeuge (nicht vom Hersteller mitgeliefert)

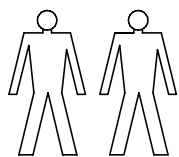
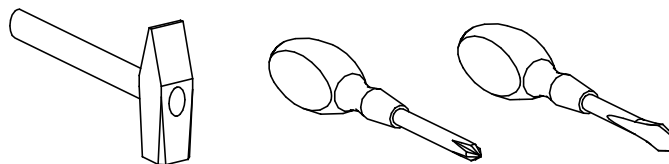

PRZED ROZPOCZĘCIEM MONTAŻU ZAPOZNAĆ SIĘ Z INSTRUKCJĄ
BITTE MONTAGEANLEITUNG BEACHTEN

W PRZYPADKU REKLAMACJI PROSZĘ OZNACZYĆ
NUMER SERII OPISANY NA ETYKIECIE OPAKOWANIA

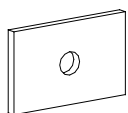

U - 16 St.

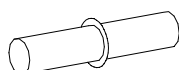

R - 16 St.

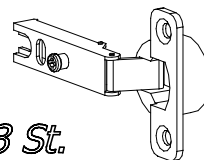

M - 3 St.

H=2

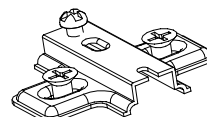

W - 3 St.

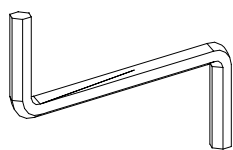

A - 16 St.
7 x 50 mm

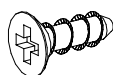

D - 18 St.
4 x 16 mm

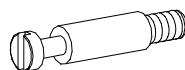

S - 8 St.

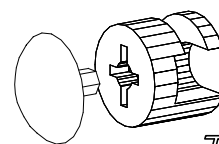

T - 8 St.

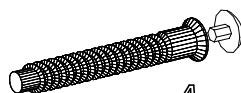

B - 6 St.

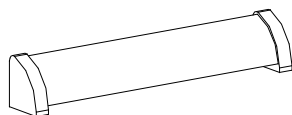

E - 3 St.

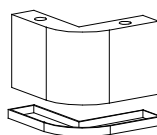

K - 5 St.



P - 10 St.
3 x 13 mm

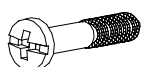

C - 6 St.

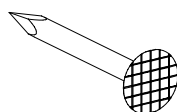

F - 70 St.

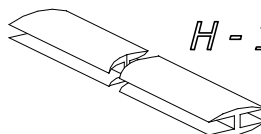

H - 1 St.



L - 50 St.

H=4

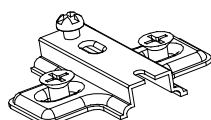

G - 6 St.

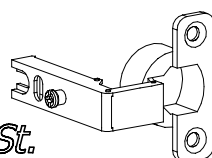

J - 1 St.

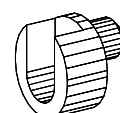

N - 2 St.