

# BIURKO

# INSTRUKCJA MONTAŻU MONTAGEANLEITUNG

NR 15

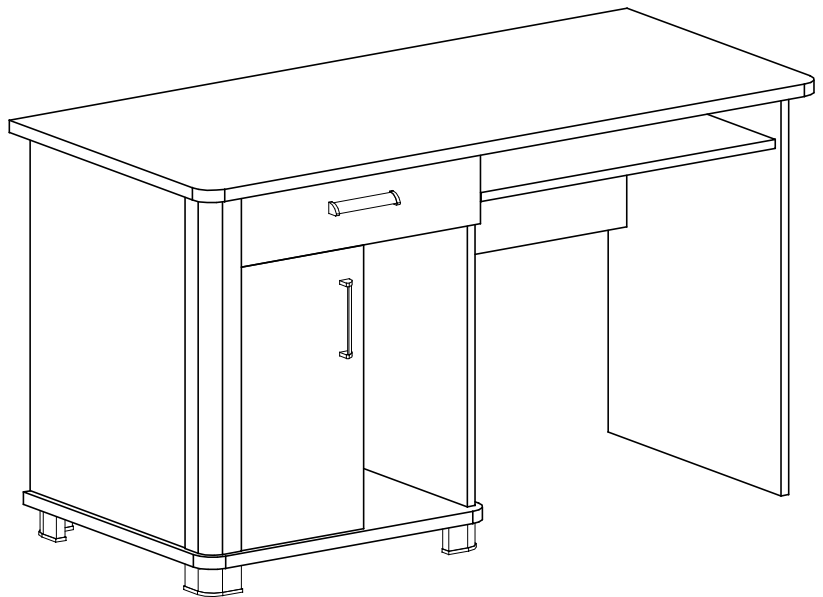

**MONTOWAĆ NA MIEKKIM PODŁOŻU TYPU: KOC, DYWAN.**

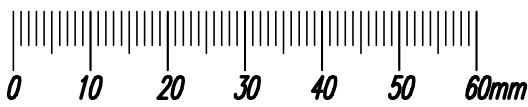
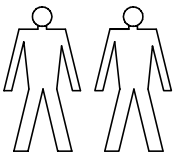

**Narzędzia niezbędne do montażu (nie dostarczane przez producenta)**  
**Zur Montage benötigte Werkzeuge (nicht vom Hersteller mitgeliefert)**

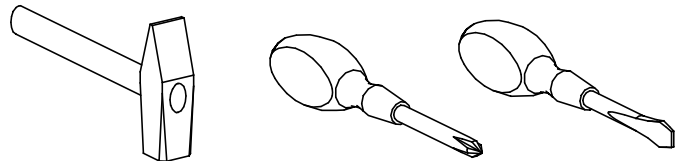

**PRZED ROZPOCZĘCIEM MONTAŻU ZAPOZNAĆ SIĘ Z INSTRUKCJĄ  
BITTE MONTAGEANLEITUNG BEACHTEN**

**W PRZYPADKU REKLAMACJI PROSZĘ OZNACZYĆ  
NUMER SERII OPISANY NA ETYKIECIE OPAKOWANIA**



**C - 16 St.**  
3 x 13 mm

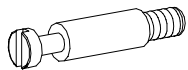
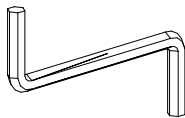

**S - 10 St.**

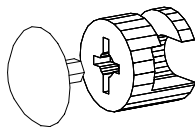

**T - 10 St.**

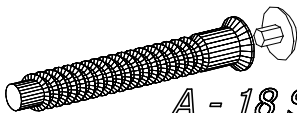

**A - 18 St.**  
7 x 50 mm

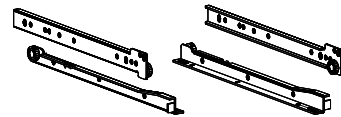

**G - 1 St.**      **L - 400mm**

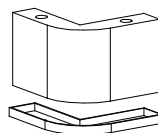

**K - 4 St.**

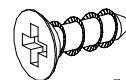

**N - 8 St.**  
euro 5 x 13 mm

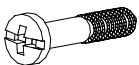

**B - 4 St.**

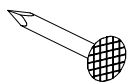

**F - 26 St.**

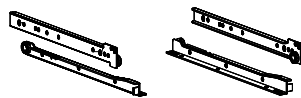

**J - 1 St.**      **L - 350mm**



**D - 4 St.**  
4 x 16 mm



**L - 56 St.**

**P - 2 St.**

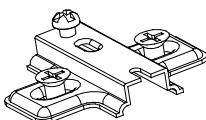

**R - 2 St.**

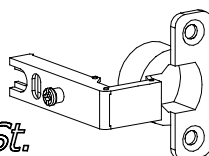

**H - 4 St.**

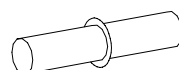

**E - 2 St.**

