

SZAFKA RTV 150

INSTRUKCJA MONTAŻU MONTAGEANLEITUNG

NR 12

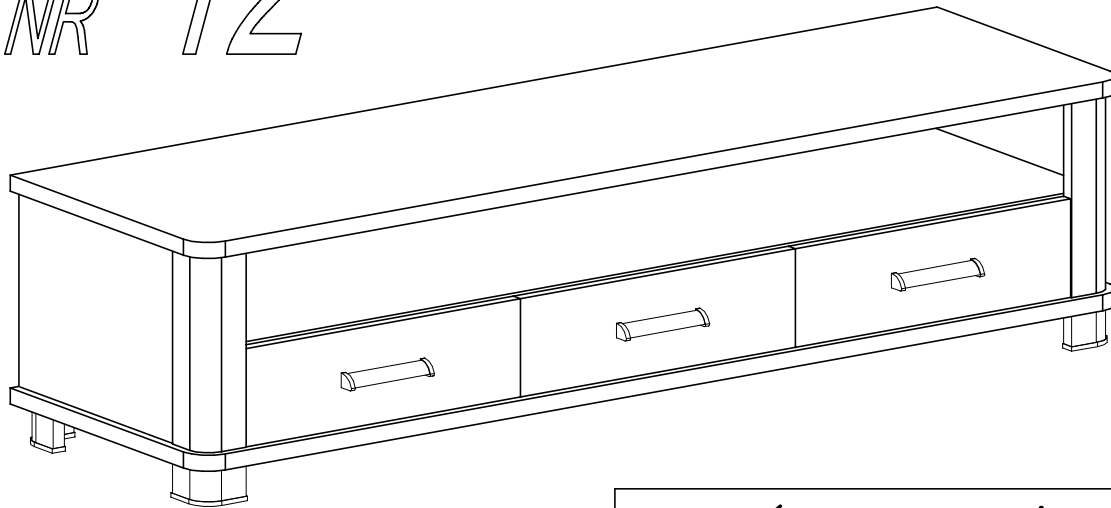

MONTOWAĆ NA MIEKKIM PODŁOŻU TYPU: KOC, DYWAN.

*Narzędzia niezbędne do montażu (nie dostarczane przez producenta)
Zur Montage benötigte Werkzeuge (nicht vom Hersteller mitgeliefert)*

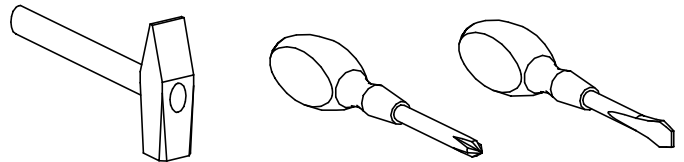
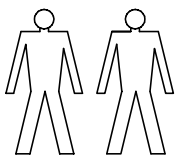

**PRZED ROZPOCZĘCIEM MONTAŻU ZAPOZNAĆ SIĘ Z INSTRUKCJĄ
BITTE MONTAGEANLEITUNG BEACHTEN**

**W PRZYPADKU REKLAMACJI PROSZĘ OZNACZYĆ
NUMER SERII OPISANY NA ETYKIECIE OPAKOWANIA**



C - 20 St.
3 x 13 mm

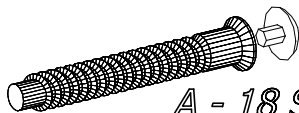

A - 18 St.
7 x 50 mm

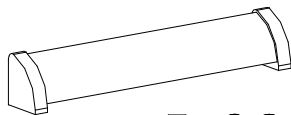

E - 3 St.

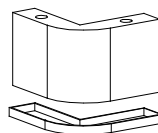

K - 4 St.

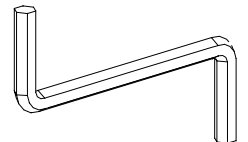

B - 6 St.

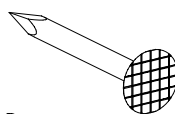

F - 60 St.

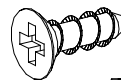

D - 12 St.
euro 5 x 13 mm



L - 72 St.

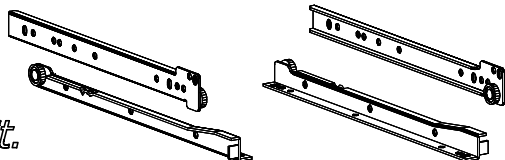

G - 3 St.

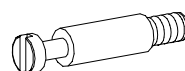

S - 18 St.

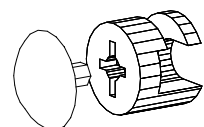

T - 18 St.