

INSTRUKCJA MONTAŻU
MONTAGEANLEITUNG

NADSTAWKA
KOMODY 120

NR 9

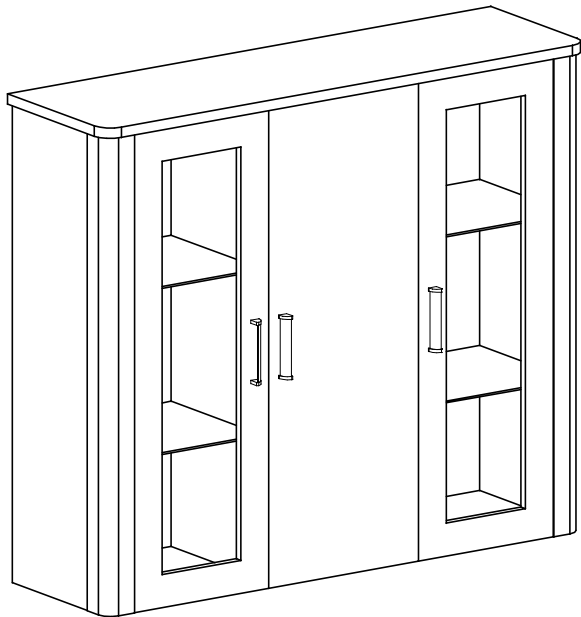

Narzędzia niezbędne do montażu (nie dostarczane przez producenta)
Zur Montage benötigte Werkzeuge (nicht vom Hersteller mitgeliefert)

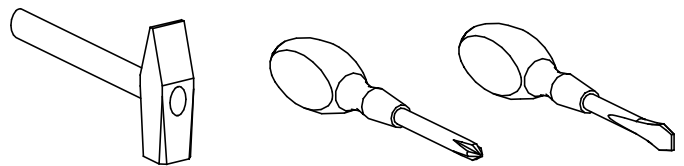

MONTOWAĆ NA MIEKKIM PODŁOŻU TYPU: KOC, DYWAN.

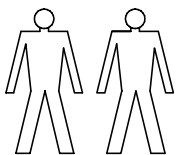

PRZED ROZPOCZĘCIEM MONTAŻU ZAPOZNAĆ SIĘ Z INSTRUKCJĄ
BITTE MONTAGEANLEITUNG BEACHTEN

W PRZYPADKU REKLAMACJI PROSZĘ OZNACZYĆ
NUMER SERII OPISANY NA ETYKIECIE OPAKOWANIA

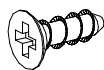
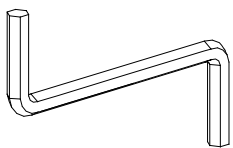

D - 12 St.
4 x 16 mm

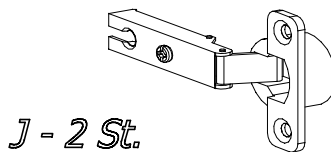

J - 2 St.



W - 2 St.
H=2

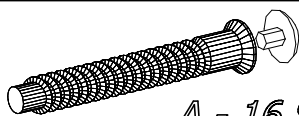

A - 16 St.
7 x 50 mm

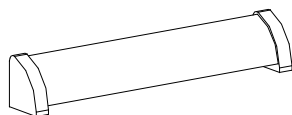

E - 3 St.

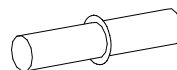

K - 8 St.

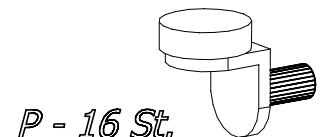

P - 16 St.

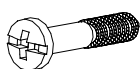

B - 6 St.

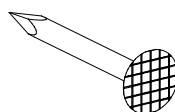

F - 48 St.

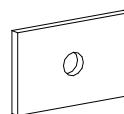

H - 12 St.



L - 28 St.

C - 4 St.
H=4

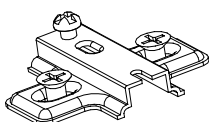

G - 4 St.

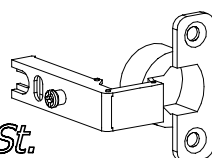

S - 6 St.

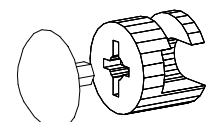
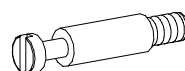

T - 6 St.