

INSTRUKCJA MONTAŻU
MONTAGEANLEITUNG

REGAŁ 50 PEŁNY

NR 4

MONTOWAĆ NA MIEKKIM PODŁOŻU TYPU: KOC, DYWAN.

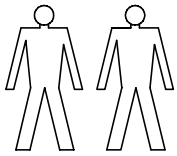

Narzędzia niezbędne do montażu (nie dostarczane przez producenta)
Zur Montage benötigte Werkzeuge (nicht vom Hersteller mitgeliefert)

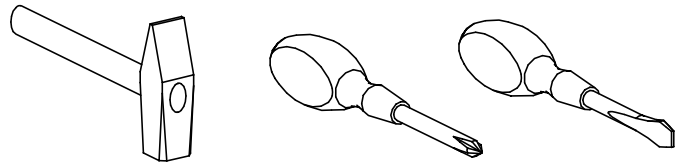

PRZED ROZPOCZĘCIEM MONTAŻU ZAPOZNAĆ SIĘ Z INSTRUKCJĄ
BITTE MONTAGEANLEITUNG BEACHTEN

W PRZYPADKU REKLAMACJI PROSZĘ OZNACZYĆ
NUMER SERII OPISANY NA ETYKIECIE OPAKOWANIA

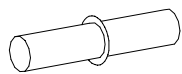
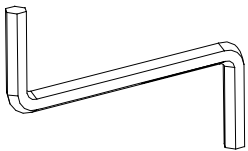

H - 12 St.

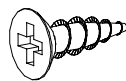

D - 6 St.
4 x 16 mm

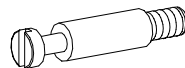

S - 12 St.

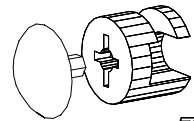

T - 12 St.

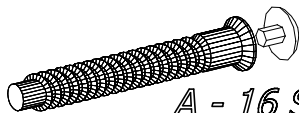

A - 16 St.
7 x 50 mm

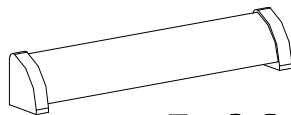

E - 3 St.

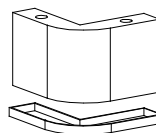

K - 4 St.

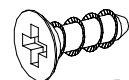

N - 8 St.
euro 5 x 13 mm

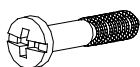

B - 6 St.

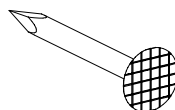

F - 56 St.



M - 16 St.
3 x 13 mm



L - 60 St.

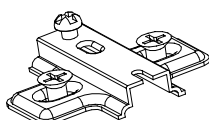

C - 3 St.

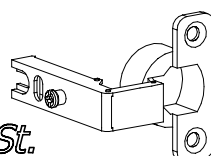

G - 3 St.

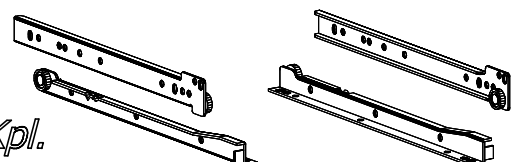

J - 2 Kpl.