

INSTRUKCJA MONTAŻU  
MONTAGEANLEITUNG

PÓŁSZafa

Lewa lub Prawa NR 2

Narzędzia niezbędne do montażu (nie dostarczane przez producenta)  
Zur Montage benötigte Werkzeuge (nicht vom Hersteller mitgeliefert)

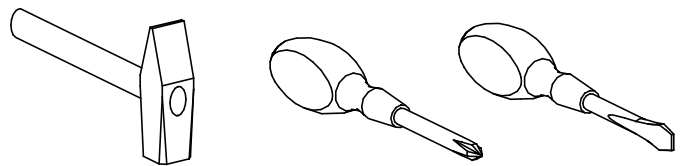

MONTOWAĆ NA MIEKKIM PODŁOŻU TYPU: KOC, DYWAN.

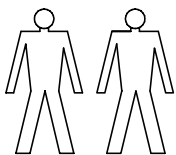

PRZED ROZPOCZĘCIEM MONTAŻU ZAPOZNAĆ SIĘ Z INSTRUKCJĄ  
BITTE MONTAGEANLEITUNG BEACHTEN

W PRZYPADKU REKLAMACJI PROSZĘ OZNACZYĆ  
NUMER SERII OPISANY NA ETYKIECIE OPAKOWANIA

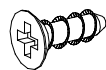
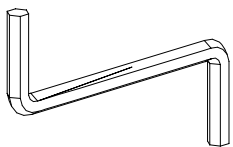

D - 6 St.  
4 x 16 mm

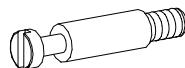

S - 8 St.

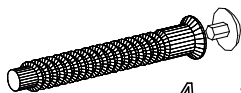

A - 12 St.  
7 x 50 mm

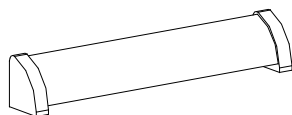

E - 1 St.

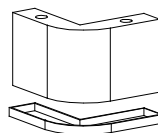

K - 4 St.



P - 8 St.  
3 x 13 mm

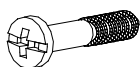

B - 2 St.

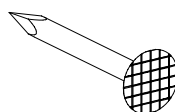

F - 48 St.

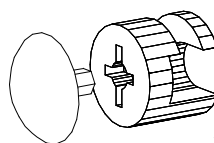

T - 8 St.



L - 42 St.

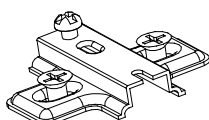

C - 3 St.

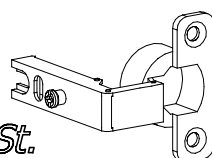

G - 3 St.

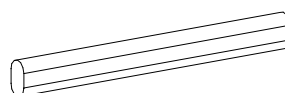

J - 1 St.

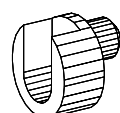

N - 2 St.